

Notice for RZ1030-4 Pump Head

Specification(unit: mm)

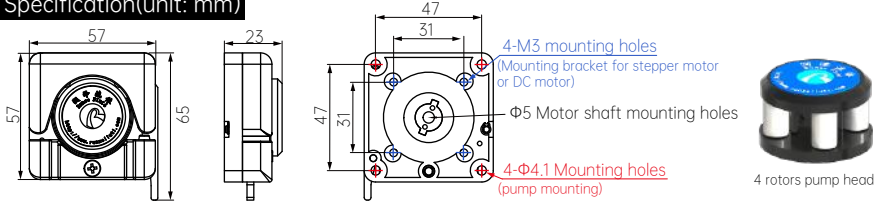

Installation on stepper motor

Steps:

1. Disassemble the pump head into A, B, C modules: A module is the rotor, use the metric M2 hexagonal wrench to disassemble the rotor lock in the middle of rotor counterclockwise; use the cross to disassemble B module, C module is the pump head base.
2. After the C module and motor are connected and screwed, insert the A module into the motor shaft as shown in Figure 2, making sure that the base of the A module and the base of the C module are in the same plane, and then locking the rotor lock clockwise.
3. At last, install the B module, the pump head installation is complete.

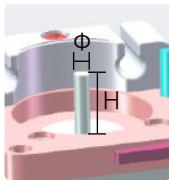

Notice:

Stepper Motor
 motor shaft length H=15~23mm
 shaft diameter Φ=5mm

DC Motor
 motor shaft length H=15~23mm
 shaft diameter Φ=6mm

DC motor mounting bracket dimensions (unit: mm)

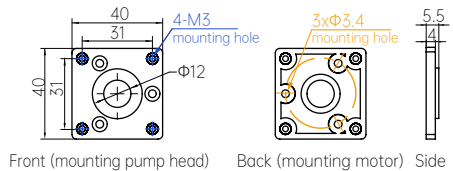

Installation on pump tube



Common Maintenance

- ◆ Please Lubricate before use for proper rotation of the peristaltic pump; Pump head tube: 9.7 cm
- ◆ Regular maintenance of the tube: when not in use for a long time, please empty the liquid in the peristaltic pump tube in time, and open the peristaltic pump protection lock and loosen the peristaltic pump tube.
- ◆ Regularly check the tube connectors: regularly check for looseness or breakage

Stepper motor peristaltic pump

BJ-RZ1030-4
TS500-RZ1030-4

Specification(unit: mm)

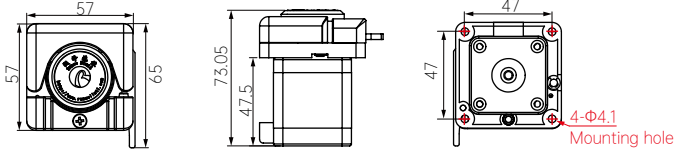
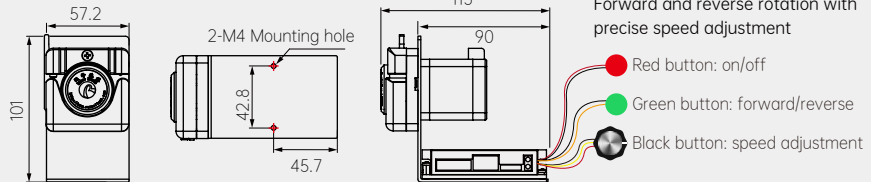
BJ-RZ1030-4: Stepper motor peristaltic pump

TS500-RZ1030-4: Stepper motor peristaltic pump + Bracket + Driver

 Standard: RUNZE MC-20A Driver
 Forward and reverse rotation with
 precise speed adjustment

● Red button: on/off

● Green button: forward/reverse

● Black button: speed adjustment

Technical Parameters

| Technical Parameters | | | NMB 42 stepper motor·Parameter | | | | Motor Wire Phase Table | | |
|----------------------|------------------------------|----------------|--------------------------------|-------|------------------|------------|------------------------|--------|--|
| Product Type | BJ-RZ1030-4 | TS500-RZ1030-4 | Max. power | 10.1W | Resistance | 4.2Ω±0.42 | Definition | Colour | |
| Speed | ≤400rpm | 1~400rpm | Step angle | 1.8° | Inductance | 5.2mH REF | A+ | Orange | |
| Net Weight | 424g | 700g | Phase | 2 | Insulation | 100m Ω MIN | A- | Blue | |
| Working Environment | Temp. 0~40°C; Humidity < 80% | | Phase volt | 4.6V | Temp. | 85°C MAX | B+ | Red | |
| Max.DB | 70dB | | Phase current | 1.1A | Insulation grade | B | B- | Yellow | |

Suitable pump hose and reference flow rate

| Suitable pump hose | Rubber Tube | | | | | | | | | | | | | | Silicone tube | | |
|-------------------------|-------------|------|------|------|------|------|------|------|------|------|-------|-------|-------|-------|---------------|-----|-----|
| | 0.8 | | | | | | | | | | | | | | 1.0 | | |
| ID (mm) | 0.64 | 0.76 | 0.89 | 1.02 | 1.14 | 1.30 | 1.42 | 1.52 | 1.65 | 1.85 | 2.06 | 2.29 | 2.54 | 2.79 | 1.0 | 2.0 | 3.0 |
| BJ-RZ1030-4 (ml/min) | 12.5 | 17.3 | 22 | 28.2 | 33.4 | 42.5 | 51.9 | 59.4 | 72.2 | 89 | 101.9 | 112.6 | 137.6 | 146.9 | 26.1 | 105 | 170 |
| TS500-RZ1030-4 (ml/min) | | | | | | | | | | | | | | | | | |

Note: 1, BJ-RZ1030-4, TS500 is the maximum reference flow rate at 400rpm

2, the above test data at room temperature 20 °C, pure water, no pressure conditions measured flow, the above data is for reference only

DC motor peristaltic pump

ZL12(24)-RZ1030-4

Specification(unit: mm)

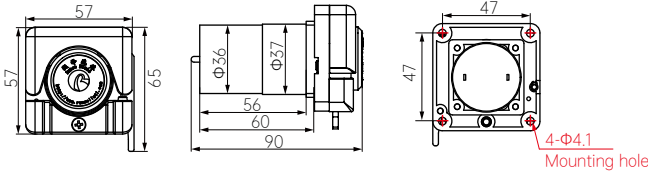

Technical Parameters

| Technical Parameters | | |
|-----------------------|------------------------------|---------------|
| Product Model | ZL12-RZ1030-4 | ZL24-RZ1030-4 |
| Motor | DC motor | |
| Motor voltage | 12V | 24V |
| Rated current | 0.04~0.2A | |
| Operating power | 15W | |
| Rotation speed option | 100/200/300rpm | |
| Weight | 429g | 427g |
| Working environment | Temp. 0~40°C; Humidity < 80% | |
| Max.DB | 75dB | |

Notice

- There are two pieces of metal protruding from the end of the DC motor, next to which engraved '+' and '-' .
- When the "+" and power "+" pole connected to the "-" and power "-" connected, forward rotation (clockwise)
- When the "+" and power "-" pole is connected, "-" and power "+" connected, reverses rotation (counterclockwise).

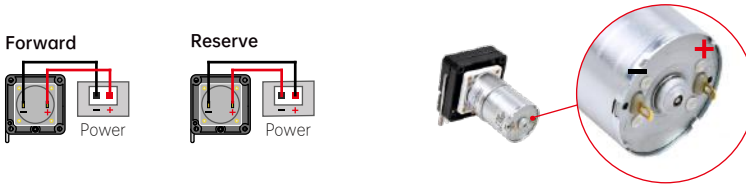

Suitable pump hose and reference flow rate

| Suitable pump hose | Rubber Tube | | | | | | | | | | | | | | | Silicone tube | | |
|------------------------|-------------|------|------|------|------|------|------|------|------|------|------|------|------|------|-----|---------------|-----|--|
| | WT (mm) | 0.8 | | | | | | | | | | | | | | | 1.0 | |
| ID (mm) | 0.64 | 0.76 | 0.89 | 1.02 | 1.14 | 1.30 | 1.42 | 1.52 | 1.65 | 1.85 | 2.06 | 2.29 | 2.54 | 2.79 | 1.0 | 2.0 | 3.0 | |
| ZL12-RZ1030-4 (ml/min) | 6 | 9 | 10 | 13 | 14 | 22 | 28 | 31 | 37 | 46 | 55 | 58 | 95 | 105 | 15 | 47 | 122 | |
| ZL24-RZ1030-4 (ml/min) | 10 | 13 | 16 | 22 | 24 | 32 | 36 | 41 | 46 | 54 | 67 | 96 | 112 | 125 | 23 | 86 | 140 | |

Note: 1, ZL12-RZ1030-4, ZL24-RZ1030-4 is the flow rate parameter for 300rpm optional speed

2, the above test data at room temperature 20 °C, pure water, no pressure conditions measured flow, the above data is for reference only